

Shore Haven Lifts

SH Distributing, Inc.
11292 Parmenter Rd.
Burbank, OH 44214
Phone: 866-444-2311
Fax: 330-264-1111
Email: sales@shdist.com
Website: www.shdist.com

Installation Manual

Model: C1264

Capacity: 1200#

Version: 1.1 Date: 7/2/10



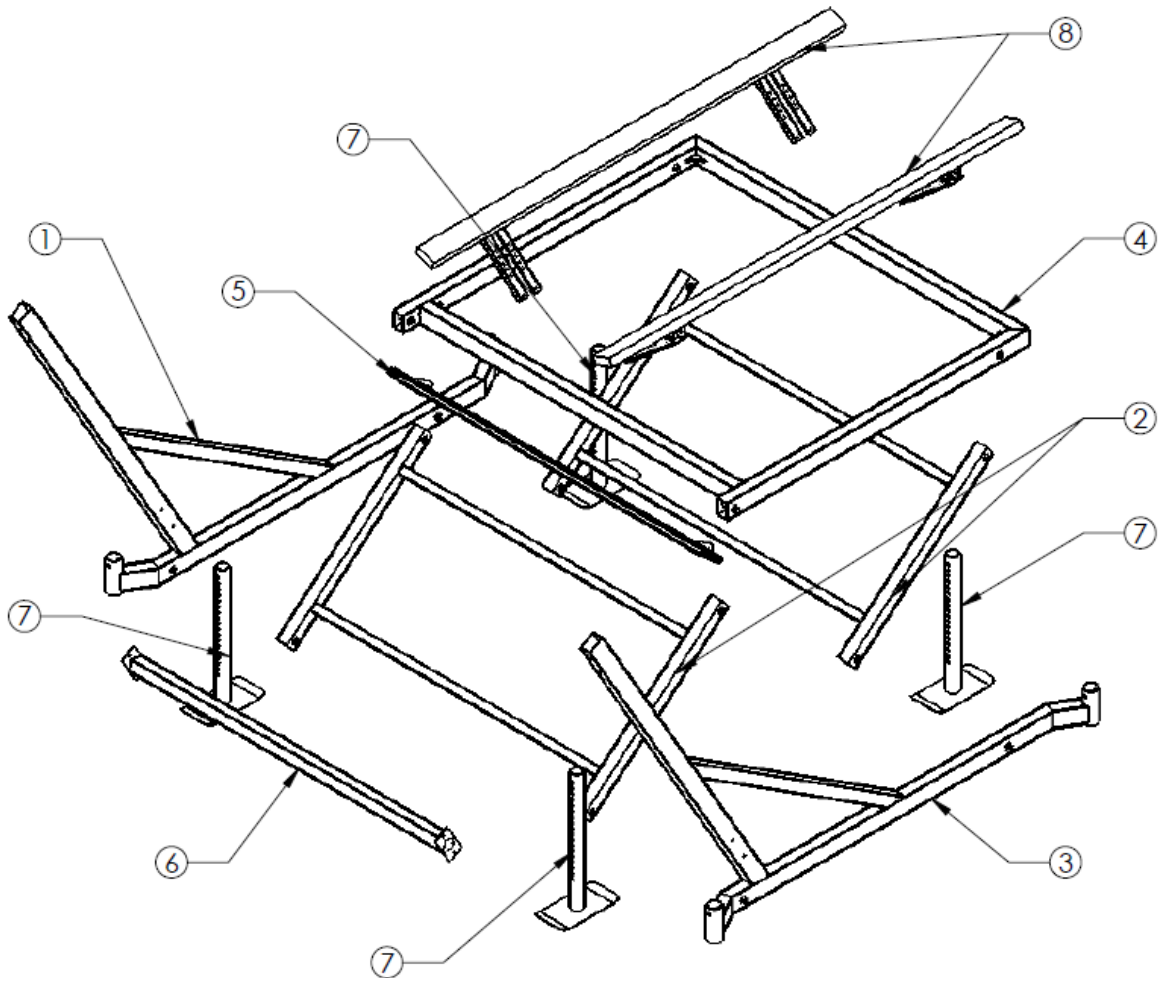

Parts Description

Assembly #	Part Number	Part Description	Weight
1	C1264-01R	Right Side Assembly	22 lbs.
2	C1264-02	Pivot Cross Frame Assembly	24 lbs. total
3	C1264-01L	Left Side Assembly	22 lbs.
4	C1264-03	Mount Frame Assembly	25 lbs.
5	C1264-08	Cable Pulley Bar Assembly	4 lbs.
6	C1264-03	Front Cross Tube Assembly	6 lbs.
7	C1264-07	Foot Assembly	12 lbs. total
8	BK24709	7' bunks	14 lbs.
Not shown	CW24	Wheel	3 lbs.
Not shown	C1264-PB	Parts Bag	20 lbs.

Total: 152 lbs.

Parts Bag

Qty.	Part #	Description
1	DBW1200	1200# brake winch
1	DBW1200H	Bag of hardware for winch
1	DLHUB	Wheel hub for winch
8	SH022	Bunk adjuster plates
1	BGC14-20	20' galv. 1/4" cable
4	SH023	Bunk pivot tubes
6	TBZ1265	1/2" x 6-1/2" bolt
3	TBZ3840	3/8" x 4" bolt
16	TBZ3830	3/8" x 3" bolt
2	TBZ3815	3/8" x 1-1/2" bolt
2	TBZ3810	3/8" x 1" bolt
6	TLNZ12	1/2" nylon lock nut
23	TLNZ38	3/8" nylon lock nut
11	TFW38	3/8" flat washer
1	TLFW38	3/8" large flat washer
8	TBS	Bunk screws
4	MC20RD	2" round plastic caps
4	APC2030RC	2"x3" plastic caps
4	APC20SQ	2" square plastic caps
1	DGHDL	Handle assembly
2	SH2AP	2" Aluminum pulley

Assembly Instructions

Step 1:

Bolt the following assembly frames together: #1 (right side assembly), #3 (left side assembly) and #6 (front cross tube).

Use the following hardware:

4 – TBZ3830 (3/8" x 3" bolts)

4 - TLNZ38 (3/8" nylon lock nut)

4 – TFW38 (3/8" flat washers) use on the outside of the left and right assembly frames

Make sure to run the bolts from inside to outside of the frame! (the washers and lock nuts should be on the out side of the frames otherwise the lift will not go all the way in the up position)

Do not tighten bolts until lift is fully assembled.

Step 2:

Bolt one assembly #2 (pivot cross frame) to the front of #1 and #3 (left and right side assemblies). Attach the other pivot cross frame (is already attached to the mount frame) to the right and left side assemblies. Make sure the drain holes are facing down on the mount frame and the extra tubing sticking out if facing forward.

Use the following hardware:

4 – TBZ1265 (1/2" x 6-1/2" bolt)

4 – TLNZ12 (1/2" nylon lock nut)

Do not tighten bolts until lift is fully assembled.

Step 3:

Attach assembly #5 (cable pulley bar) to the mount frame and front pivot cross frame.

Use the following hardware:

2 – TBZ1265 (1/2" x 6-1/2" bolt)

2 – TLNZ12 (1/2" nylon lock nut)

Step 4:

Tighten up all of the bolts. The 6 bolts attached to the pivot cross frames, make sure there is an approximately 1/8" gap between the bushings. Do not over tighten because these frames need to pivot.

Step 5:

Bolt the DBW1200 (brake winch) to one of the side assemblies that the wheel is going to be on (normally the left side assembly but can be put on the right side assembly). Make sure that the threaded shaft is to the outside of the hoist.

Use the following hardware:

2 – TBZ3840 (3/8" x 4" bolt)

2 – TLNZ38 (3/8" nylon lock nut)

4 – TFW38 (3/8" flat washer)

Tighten up bolts.

Step 6:

Attach BGC14-20 (20' galv. 1/4" cable) to the opposite side that the winch is attached to. Place in the top hole of the side assembly. Make sure to use the large flat washer on cable end.

Use the following hardware:

1 – TBZ3840 (3/8" x 4" bolt)

1 – TLNZ38 (3/8" nylon lock nut)

1 – TFW38 (3/8" flat washer)

1 – TLFW38 (3/8" large flat washer)

Tighten up bolts.

Step 7:

Run the cable through the cable pulley bar assembly (start on the side that the cable is attached to the hoist and run it towards the winch side). Attach the cable to winch by following directions provided by the winch manufacture.

Step 8:

Install two SH2AP (2" aluminum pulleys) to the pulley bar.

Use the following hardware:

2 – TBZ3812 (3/8" x 1-1/2" bolt)

2 – TLNZ38 (3/8" nylon lock nut)

Tighten up bolts.

Step 9:

Bolt 1 – DLHUB (wheel hub for winch) to 1 - CW24 (wheel) using the following hardware:

1 – DLHUB (Wheel hub for winch)

1 - CW24 (Wheel)

2 - TBZ3810 (3/8" x 1" bolt)

2 - TFW38 (3/8" flat washer)

2 - TLNZ38 (3/8" nylon locking nut)

Make sure to use the flat washer on the outside of the wheel and run the bolts into the wheel hub.

Step 10:

Attach wheel to winch by screwing it onto the winch. This should go on easily. The winch should make a clicking noise when screwed all the way on. Use the spring and nut in small bag

provided by winch to tighten on winch. Just tighten enough to lock the nut on the bolt. If this is over tightened, the brake on the winch will not work properly.

Step 11:

Install the spinner knob with hardware already installed on the knob. Remove the nut and lock washer. Place on wheel and use lock washer and nut to tighten up.

Step 12:

Install bunks using the following parts:

2 - BK24709 (7' bunk)

8 - SH022 (bunk adjuster plate)

4 - SH023 (bunk pivot tube)

8 - TBS (bunk screw)

12 - TBZ3830 (3/8" x 3" bolt)

12 - TLNZ38 (3/8" nylon locking nut)

Place bunks upside down on top of assembly #4 (Mount frame) and center the bunks. Place SH023 (bunk pivot tubes) on the bunks where the frame crosses the bunks. Make sure that the screw holes for the pivot tubes are towards the outside edges of the bunks. Screw the pivot tubes in place. Use the 12 - TBZ3830 (3/8" x 3" bolt) and TLNZ38 (3/8" nylon locking nut) to bolt the bunks to assembly #4 (Mount frame).

Step 13:

Install end caps:

Install 4 - APC238SQ (2 round plastic caps): 4 on assembly #7 (feet assembly)

Install 4 - APC2030RC (2"x3" plastic caps): 1 on assembly #1 (right side assembly), 1 on assembly #3 (left side assembly), and 2 on assembly #4 (mount frame assembly)

Install 4 - APC20SQ (2" square plastic caps): 4 on top of assembly #5 (pivot cross frame)

Step 14:

Install stickers:

Install 1 - KSSG (safety guide sticker) on C1264-01L (left side assembly) just next to where the winch is attached to.

Install 2 - KSPP (pinch point stickers) on assembly #5 where the pulleys are located.

Step 15:

Test operation of lift to make sure it raises and lowers easily without binding. Adjust legs to desired height to make level. Adjust bunks properly to fit PWC.

Shore Haven Limited Warranty

SH Distributing Inc. warrants its Shore Haven Boat Lifts to the original owner that its products are free of defects in materials and workmanship under normal and proper use.

~15 year warranty – on aluminum structure and welds

~ 2 year warranty – on components and options excluding those that carry their own manufacturer's warranty, where this applies. (such as winches and canopies)

SH Distributing Inc. obligations under this warranty are limited to, at their sole discretion, providing a replacement part, or repair or replace the lift upon return of product to the place of purchase by customer with proof of purchase and purchase date.

This warranty does not cover any mishandling, misuse, neglect, failure to follow operating instructions or manuals of installation, maintenance repair or improper installation. Warranty also excludes any damage resulting from storms, high winds, ice, salt water or any acts of nature.

SH Distributing Inc. is not to be held responsible for any removal or installation charges associated with any warranty repairs or replacement.

IN NO EVENT SHALL SH DISTRIBUTING INC. BE LIABLE FOR ANY INCIDENTAL OR CONSEQUENTIAL DAMAGES OF ANY KIND.